



All-In-One Sealing Head Adjustment Guide

Before operating your induction sealer please familiarize yourself with these setup instructions. Proper alignment is critical to guarantee optimal uptime and production speed.



Align the power supply and sealing head over the conveyor with the sealing head in the 20-38mm position.

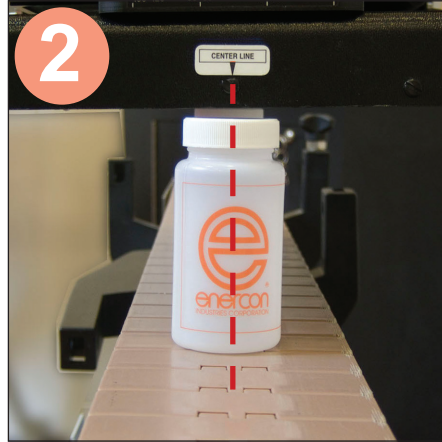

Ensure the product runs centered along the entire length of the sealing head. (Use a gap gauge to create the proper air gap between the product and the Enercon induction sealer (0.125" or 3 mm)).

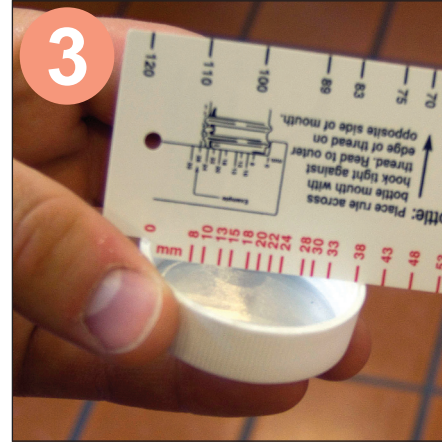

Measure the inner diameter of the cap to select the proper position to pivot the sealing head. (Refer to chart for pivot ranges)

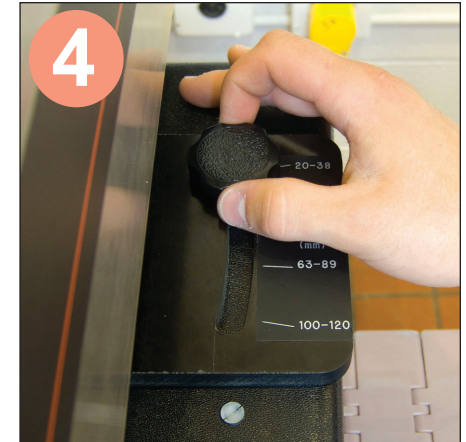

Loosen the knobs on both sides of the sealing head, pivot the sealing head to the correct position and tighten.

Pivot Ranges	Image
20-38mm	
43-58mm	
63-89mm	
100-120mm	

The All-in-One sealing head has four different pivot points to seal caps ranging from 20-120mm.

